

## New Construction Housing w/ 5"/6" 800Lm GU24

6"

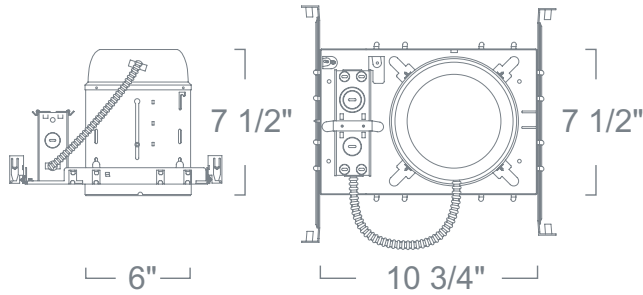

### SPECIFICATION

Ceiling cut-out: 6 1/2"

**Application:** General purpose housing specially designed for use with Liton's LRELD6 Series Retrofit-able GU24 LED Trims and Cree's LR6 LED Module.

**Housing:** Pre-wired housing adjusts up to a 1-1/2" ceiling thickness. Integral thermal protector to guard against improper lamping and installation. Trim is secured with torsion wing springs/standard coil springs or serrated clips.

**Mounting:** Housing suitable for new construction installations only, supplied with (2) 24" adjustable hanger bars with 90 degrees repositioning ability. Hanger bars equipped with nail-less install 3/4" serrated barbed studs and with captive nails, for faster and easier secure mounting in wood joists. Set-screws lock into position and prevent shifting after installation. Earthquake structural cable compatible for drop panel ceiling or any other mounting that requires direct support from structural ceilings.

**Junction Box :** 16 gauge pre-wired galvanized steel Junction Box, 32 cubic-inch for a maximum of (8) #12 AWG wires. Furnished with (7) 3/4" and (4) Romex knock-outs. Strain clamps to install or remove covers for easy access and ground wire. Equipped with safety standard fitting for flex-conduit.

**Insulation Contact:** IC rated housing rated for direct contact with loosefill blown and rolled insulation.

**Airflow:** Airtight option is designed to restrict air flow from room into plenums in compliance to the WSEC - Washington State Energy Code, (Less than 2.0 CFM -Cubic Feet per Minute). Complies to Title24 air flow requirements (Air-tight).

**Safety Labels:** UL/CUL listed for through-branch wiring (8) No.12 AWG 90°C and suitable for damp locations. NYC approved: Calendar #41937.

**Insulation Contact:** Energy Efficient LED housing comes standard with IC rating for direct contact with loosefill blown and rolled insulation.

**Caution:** Use of any 3rd party lamp source in this unit is subject to the lamp/module manufacturer's own limitations. In no way does LITON make any claims to compatibility in regards to form, fit, usage and case temperature conditions with other manufacturer's products. Users are responsible for confirming compatibility under all aforementioned conditions before using this product.

**Caution:** LITON recommends use of surge protectors on the power entering LED Housings. Surge damage is not covered by warranty.

### FEATURE:



**Application:** General Purpose LED Trim for Retrofit, New Construction and Remodel Applications in low to medium height ceilings. Qualified as high efficacy for Title 24 by the California Energy Commission.

**Mounting:** Mounts into standard 6" General Purpose Recessed housing with steel pressure springs mounted on trim to ensure positive retention inside housing.

**Lumen Maintenance:** Minimum 50,000 hours L70 life based on ANSI TM-21 calculations from LM80 standardized test results.

**Thermal Management:** Effective thermal dissipation facilitated by integral cast-aluminum, finned heat sink design for maximum heat rejection to provide long LED life.

**Driver:** Electronic Direct Current driver mounted in fixture. Comes standard with dimming. Smoothly dims down to 10% with standard Incandescent and Electronic Low Voltage dimmers. Not recommended for 3-Way Dimmers

**Color Temperature:** Comes with 3,000K Warm White LED's binned according to ANSIC78 377A for color temperature and chromaticity ranges. Available with other color temperatures with ANSI binning between 2700K and 6500K. To order use "-T" Suffix followed by color temperature, consult factory as extended lead times and minimum order apply.

**Safety Labels:** ETL/CETL listed. Suitable for damp locations. NYC approved: Calendar #41937.

**Warranty:** Covered by a 3 Year Warranty to be free of defects in materials and craftsmanship. Recommended for applications where ambient temperatures do not exceed 35°C, installations exceeding this temperature will result in reduced LED lamp life and a voided warranty.

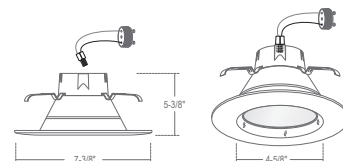

### NEW CONSTRUCTION HOUSING

LH71CA-LLF-GU24 LED

#### DESCRIPTION

LH71CA-LLF-GU24: New Construction Housing

### 5"/6" 800LM GU24

LRLD6 120V LED

#### FINISH

LRLD6B-GU24 :Black Reflector/Black Ring\*

LRLD6W-GU24 :White Reflector/White Ring

#### COLOR TEMPERATURE

Blank :3000K

-T27 :2700K\*

\* Special Order

Ordering example: LH71CA-LLF-GU24/LRLD6B-GU24-T27

## LRLD6-GU24 - PHOTOMETRY

### 5" & 6" GU24

#### LRLD6-GU24 - 3,000K

System Power	: 10.6W	Multipliers	
Test Date	: 9/2016	2,700K	0.95
Beam Angle 50%	: 95.5°		
Field Angle 10%	: 140.9°		
Color Temperature	: 3,022K		
CRI	: 93.6		
R9 Value	: 68.2		
Lumens Delivered	: 902Lm		
CBCP	: 391cd		
Power Factor	: 0.87		

#### CANDELA TABULATION

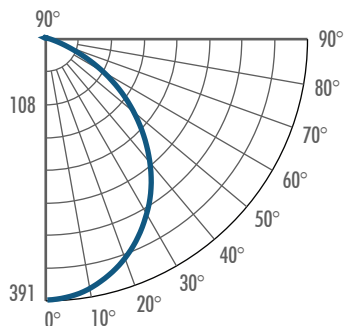

#### FOOTCANDLE DISTRIBUTION

Height	Beam Diameter	FC
6'	13.2'	10.9
8'	17.6'	6.1
10'	22.0'	3.9
12'	26.4'	2.7
14'	30.8'	2.0